

EXISTING + PROPOSED ACCESS

-  PUBLIC TRANSPORT
-  PEDESTRIAN PATH
-  DIRECT ACCESS TO NEW ELP
-  ENTRY INTO CENTRE
-  ENTRY INTO PROPOSED ELP

Key Plan  
- This document describes a Design Intent only  
- Written dimensions take precedence over scaling and are to be checked on site  
- Refer to all project documentation before commencing work  
- Copyright is retained by Scentre Design and Construction  
- Written authority is required for any reproduction

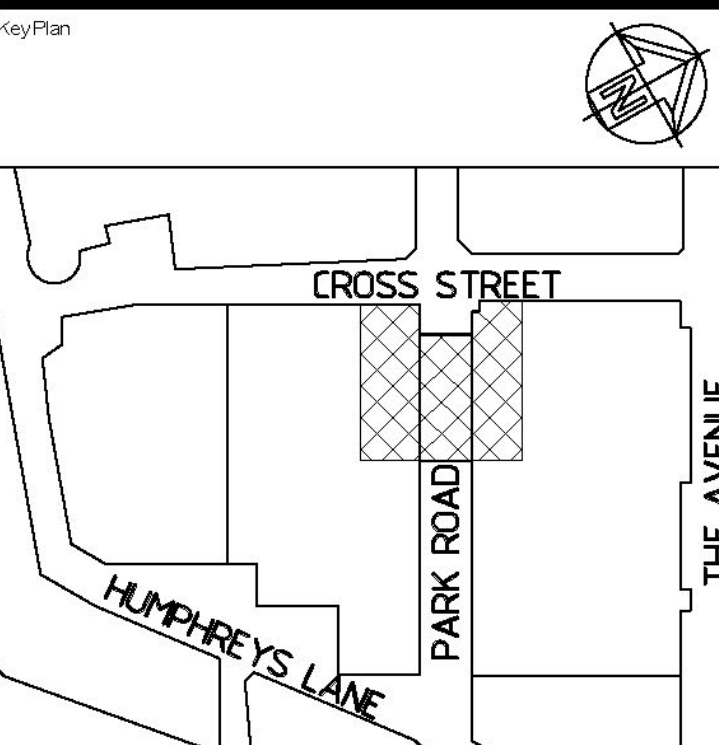

dexus

SCENTRE GROUP

WESTFIELD HURSTVILLE

DEVELOPMENT APPLICATION

Scentre Design & Construction Pty Limited  
86 Castlereagh Street Sydney NSW 2000  
Phone (02) 9558 7000 Fax (02) 9558 8500  
GPO Box 4004 Sydney NSW 2001  
ACN 000 207 205

ACCESS AND WAYFINDING  
LEVEL R1

Drawing Scale: Scale Bar 1:1  
NTS 0 10 20 30 40 50

Project No: 1605 Drawing No: 01.8400 Revision: A

Internal Wayfinding signage to be updated to increase visual permeability to the connection to the ELP.

PEDESTRIAN MOVEMENT & ACCESS : RETAIL LEVEL 1





TRAIN STATION  
& HURSTVILLE  
PLAZA

## EXISTING + PROPOSED ACCESS

- PUBLIC  
TRANSPORT
- PEDESTRIAN PATH
- DIRECT ACCESS  
TO NEW ELP
- ENTRY INTO  
CENTRE
- ENTRY INTO  
PROPOSED ELP

**Key Plan**  
- This document describes a Design Intent only  
- Written dimensions take precedence over scaling and are to  
be checked on site  
- Refer to all project documentation before commencing work  
- Copyright is retained by Scentre Design and Construction  
- Written authority is required for any reproduction

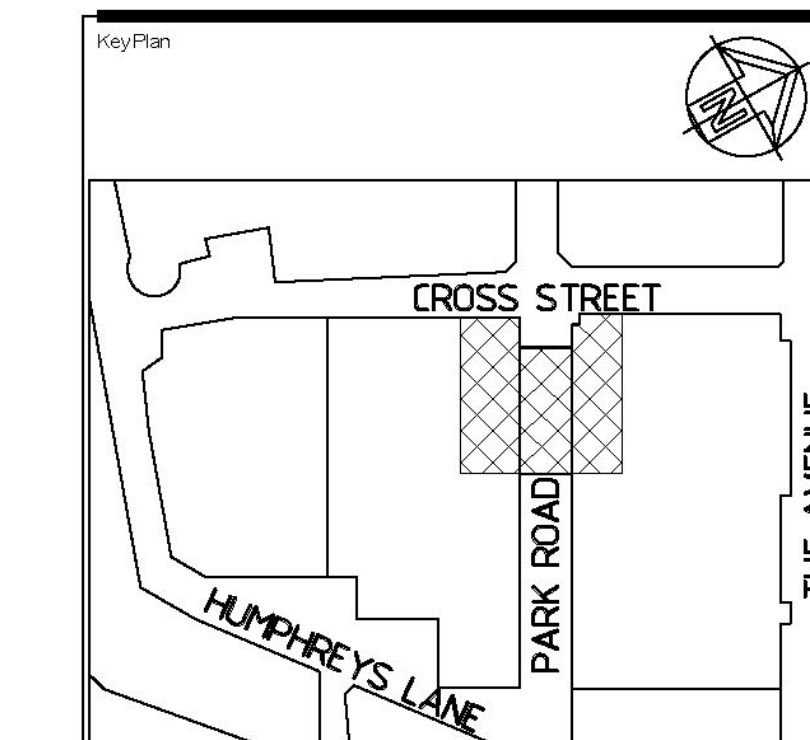

**dexus**

**SCENTRE  
GROUP**

**WESTFIELD  
HURSTVILLE**

**DEVELOPMENT  
APPLICATION**

Scentre Design & Construction Pty Limited  
85 Castlereagh Street Sydney NSW 2000  
Phone (02) 9558 7000 Fax (02) 9558 8500  
GPO Box 4004 Sydney NSW 2001  
ACN 100 207 205

**ACCESS AND  
WAYFINDING  
LEVEL R2**

Drawing Scale: Scale Bar 1:1  
NTS 0 10 20 30 40 50

Project No: Drawing No: Revision:  
1605 01.8401 A

Internal Wayfinding signage to be updated to increase  
visual permeability to the connection to the ELP.

# PEDESTRIAN MOVEMENT & ACCESS : RETAIL LEVEL 2



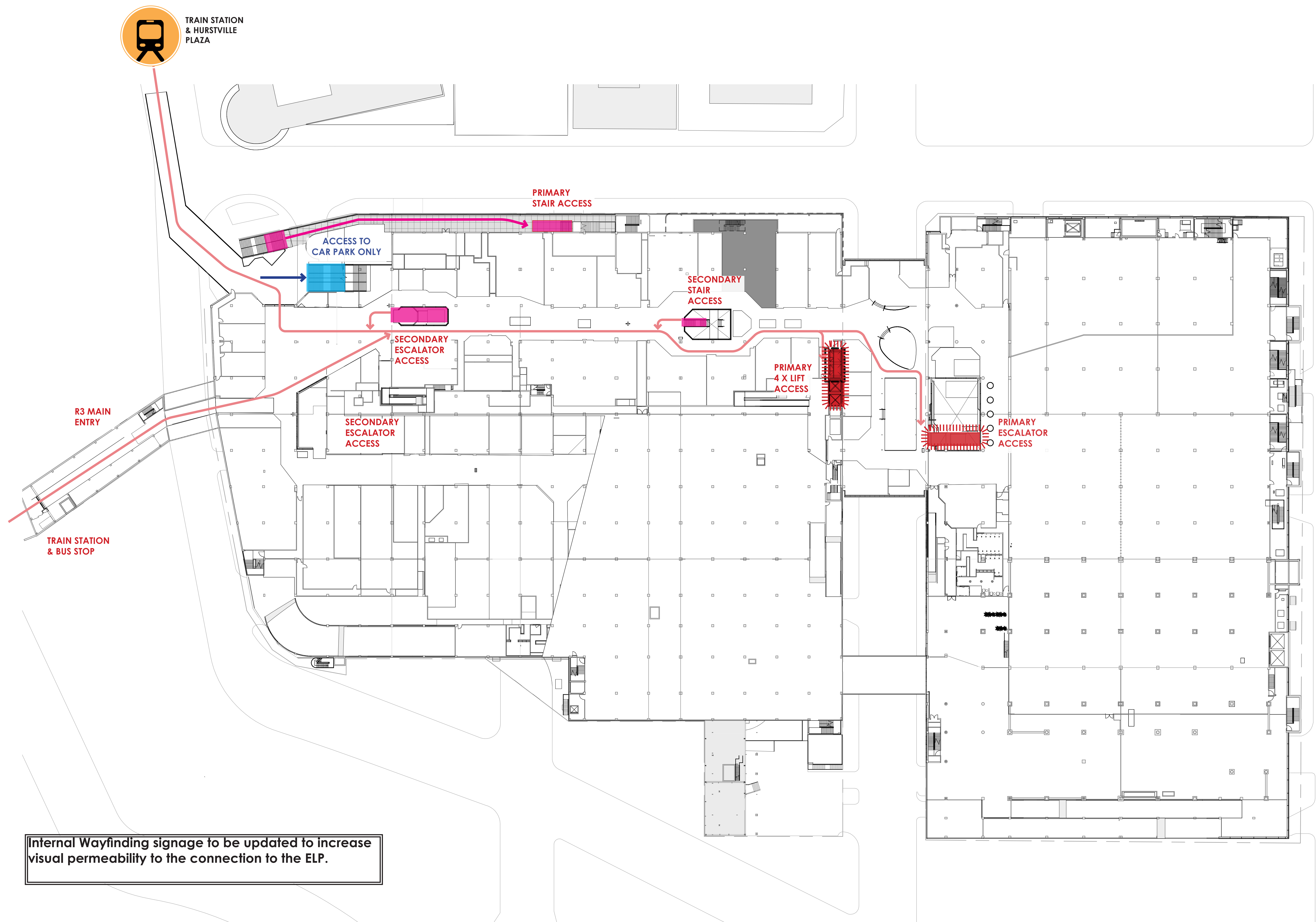

## EXISTING + PROPOSED ACCESS

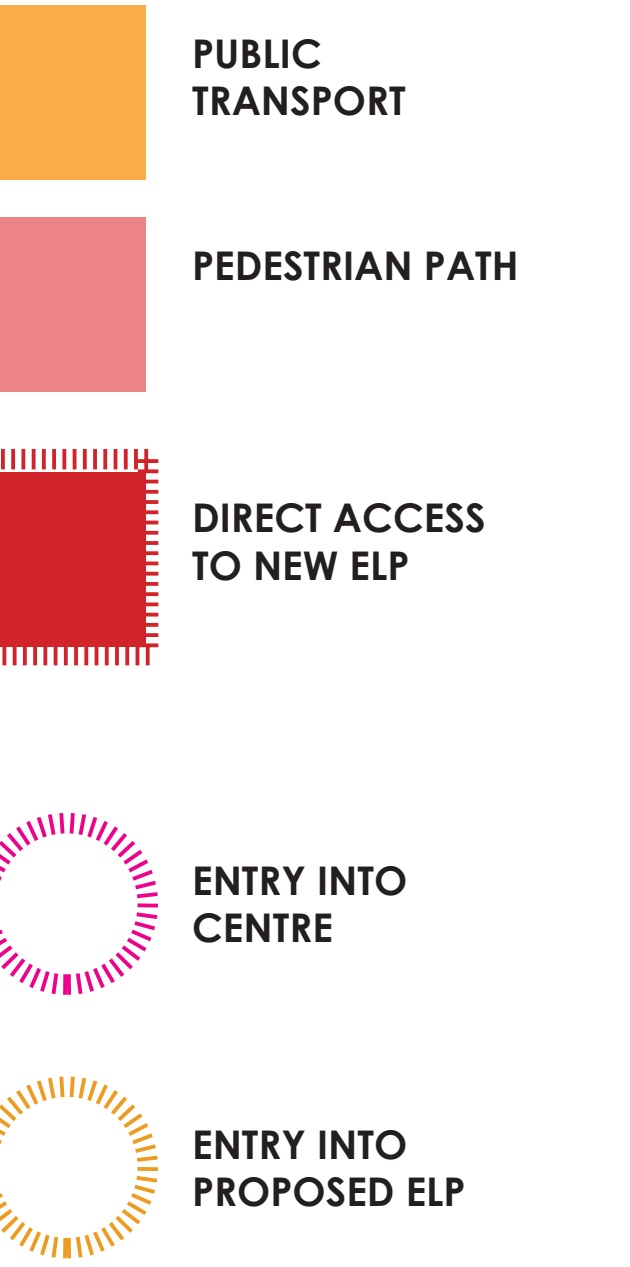

Key Plan  
 - This document describes a Design Intent only  
 - Written dimensions take precedence over scaling and are to be checked on site  
 - Refer to all project documentation before commencing work  
 - Copyright is retained by Scentre Design and Construction  
 - Written authority is required for any reproduction

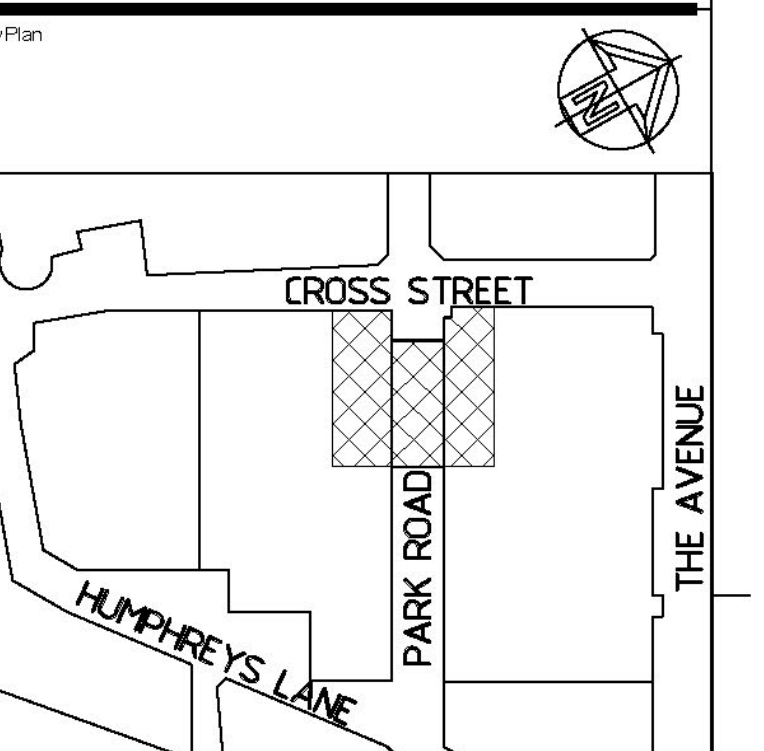

dexus

SCENTRE GROUP

WESTFIELD HURSTVILLE

DEVELOPMENT APPLICATION

Scentre Design & Construction Pty Limited  
 85 Castlereagh Street Sydney NSW 2000  
 Phone (02) 9558 7000 Fax (02) 9558 8000  
 GPO Box 4004 Sydney NSW 2001  
 A21/000 207 205

ACCESS AND WAYFINDING LEVEL R3

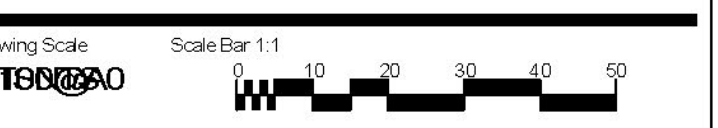

Project No. Drawing No. Revision  
 1605 01.8402 A

# PEDESTRIAN MOVEMENT & ACCESS : RETAIL LEVEL 3



EXISTING + PROPOSED ACCESS

-  PUBLIC TRANSPORT
-  PEDESTRIAN PATH
-  DIRECT ACCESS TO NEW ELP
-  ENTRY INTO CENTRE
-  ENTRY INTO PROPOSED ELP

Key Plan  
- This document describes a Design Intent only  
- Written dimensions take precedence over scaling and are to be checked on site  
- Refer to all project documentation before commencing work  
- Copyright is retained by Scentre Design and Construction  
- Written authority is required for any reproduction

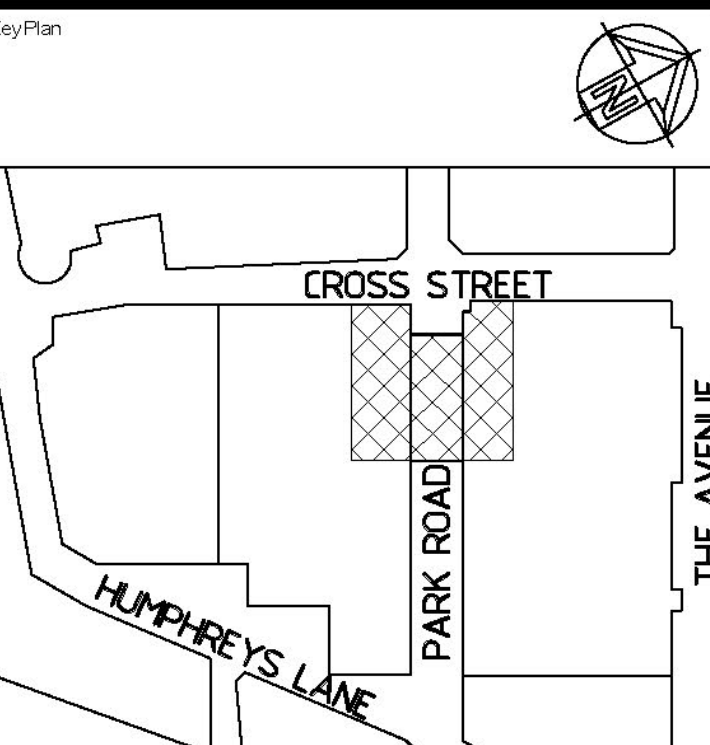

dexus

SCENTRE GROUP

WESTFIELD HURSTVILLE

DEVELOPMENT APPLICATION

Scentre Design & Construction Pty Limited  
85 Castlereagh Street Sydney NSW 2000  
Phone (02) 9558 7000 Fax (02) 9558 8500  
GPO Box 4004 Sydney NSW 2001  
ACN 100 207 205

ACCESS AND WAYFINDING  
LEVEL R4

Drawing Scale: Scale Bar 1:1  
NTS 0 10 20 30 40 50

Project No. Drawing No. Revision  
1605 01.8403 A

Internal Wayfinding signage to be updated to increase visual permeability to the connection to the ELP.

PEDESTRIAN MOVEMENT & ACCESS : RETAIL LEVEL 4